

ROOM SIZE 80' X 50'

Harrison High School

STRENGTH AND CONDITIONING FACILITY

DESIGNED BY: PRO Industries - Chris Lynch 800-875-5448 FRANKLIN, IN SCALE: 1" = 8' DATE: 08-09

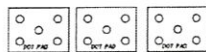
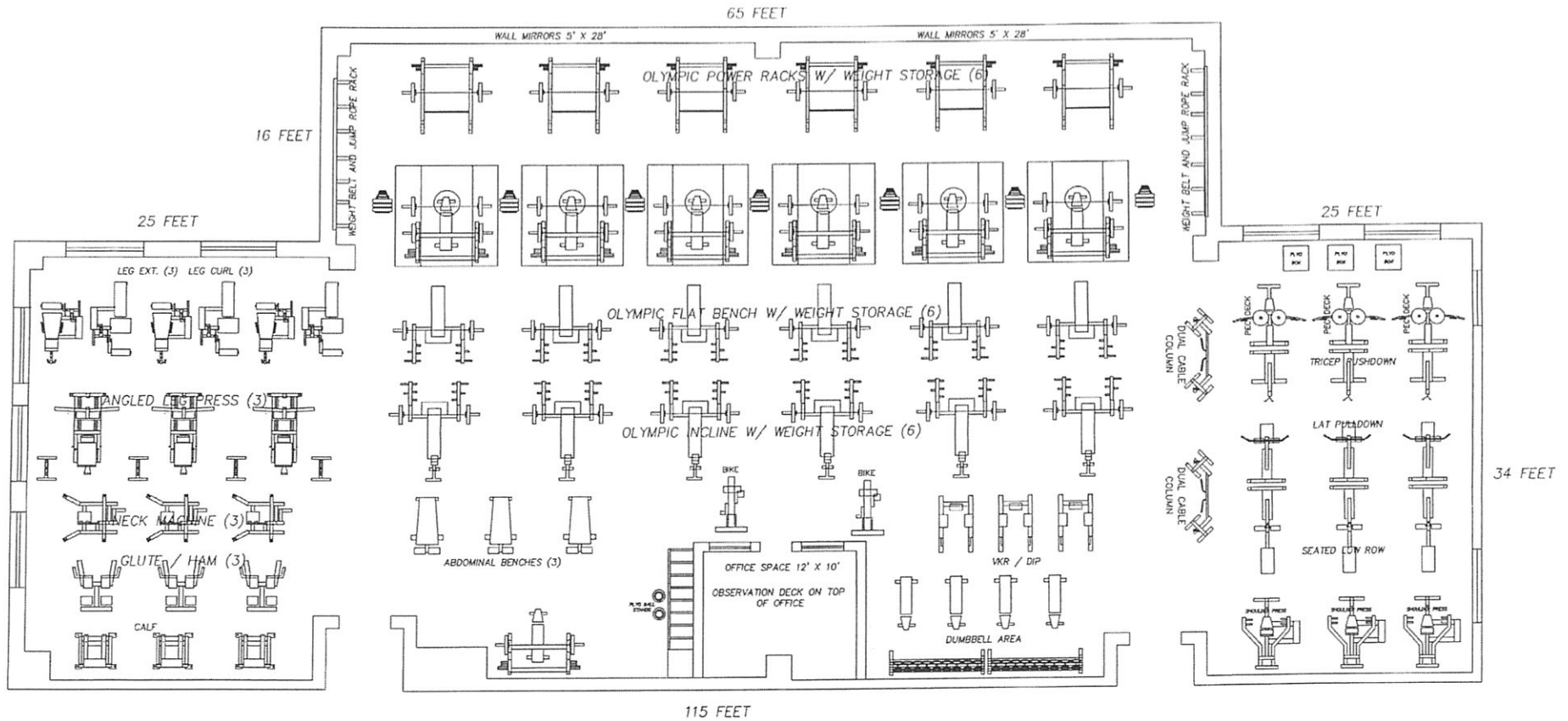

Franklin Community High School

STRENGTH AND CONDITIONING FACILITY

DESIGNED BY: PRO Industries - Chris Lynch 800-875-5448 FRANKLIN, IN SCALE: 1" = 8' DATE: 8-05

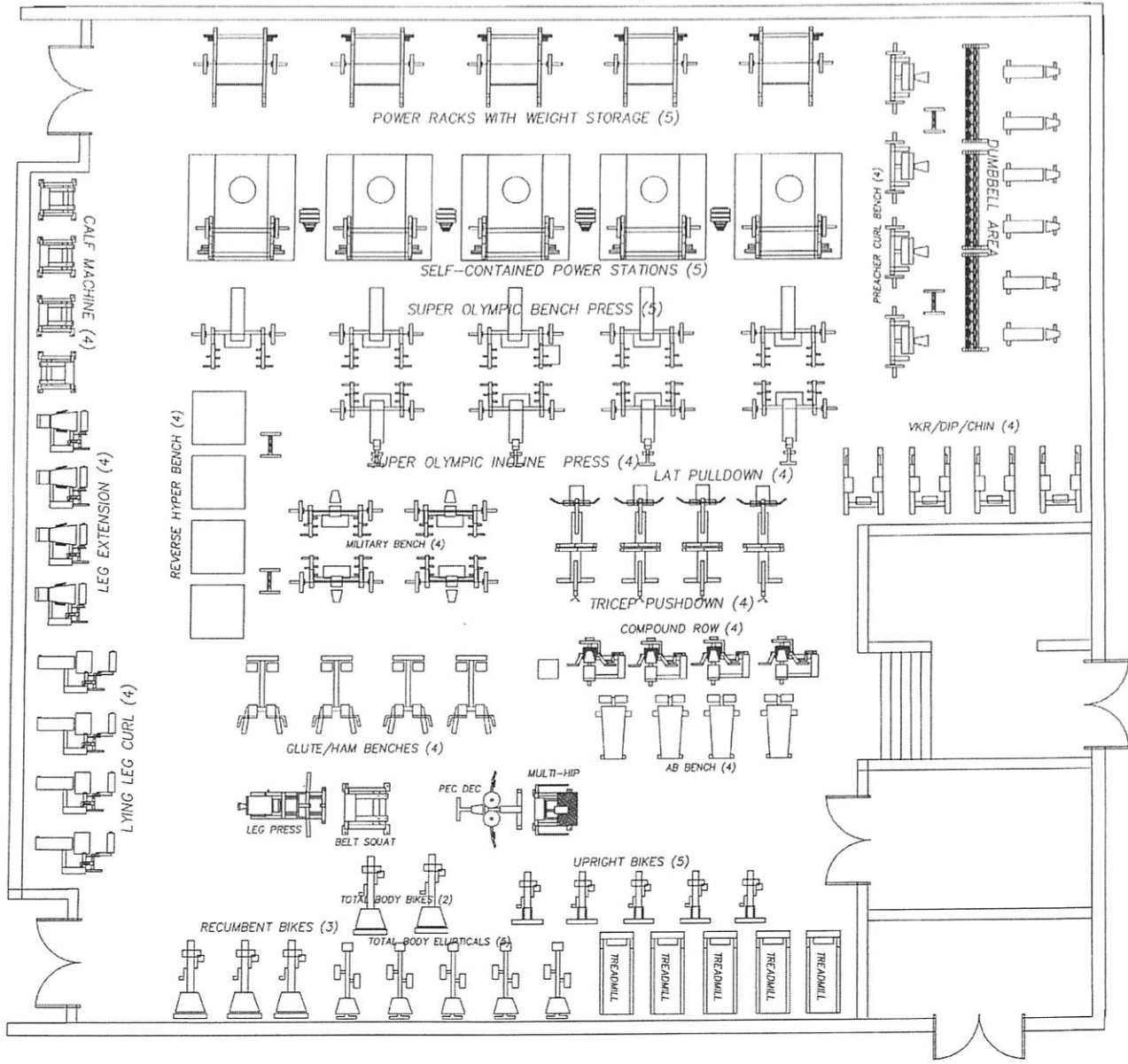

ROOM SIZE = 80' X 75' = 6000 SQFT

Ft. Wayne Carroll High School
 STRENGTH AND CONDITIONING FACILITY
 DESIGNED BY: PRO Industries - Chris Lynch 800-875-5448 FRANKLIN, IN
 SCALE: 1" = 8'
 DATE: 5-07

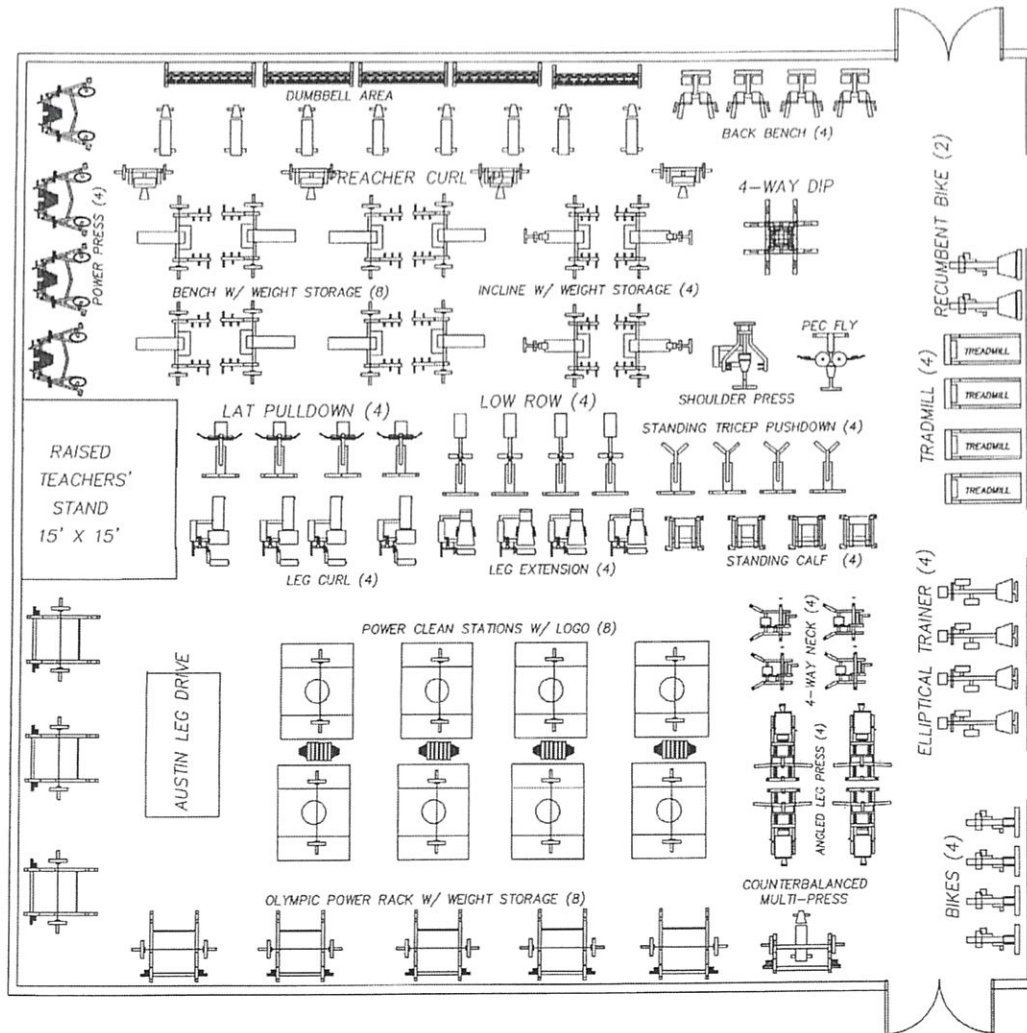

ROOM SIZE 85' X 80' = 6800 SQ FT

Decatur Central High School

STRENGTH AND CONDITIONING FACILITY

DESIGN BY: PRO INDUSTRIES, C. LYNCH 1-800-875-5448 FRANKLIN, IN SCALE: 1" = 10' DATE: 09/25/06

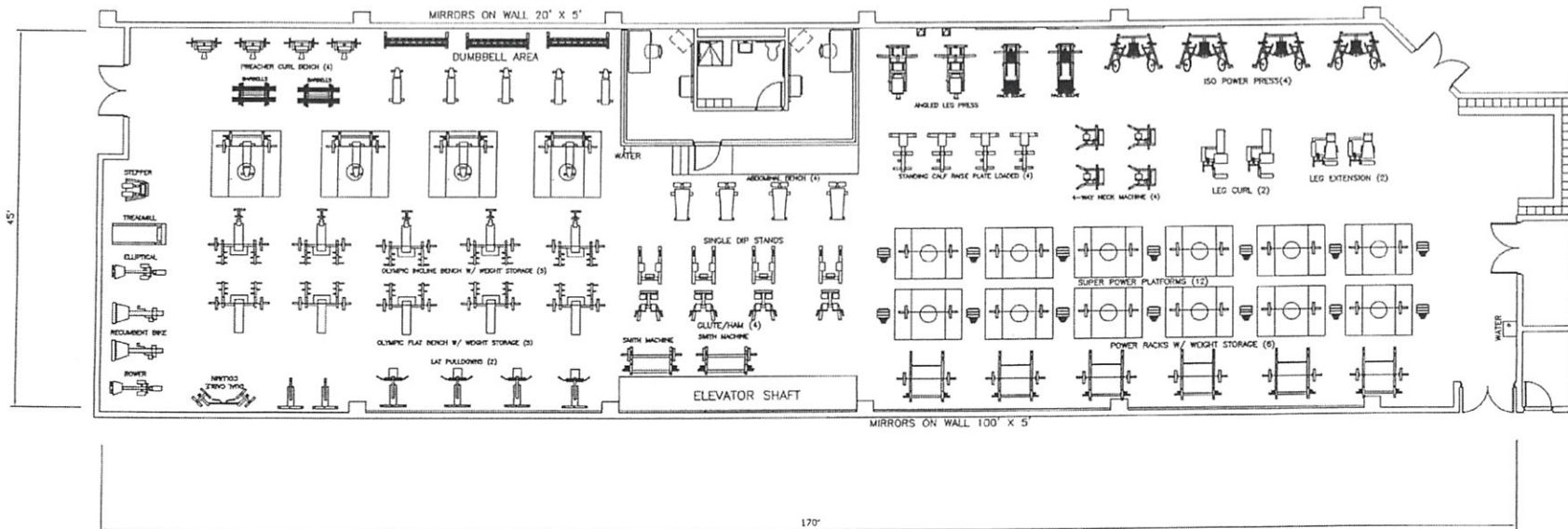

Warren Central High School

STRENGTH AND CONDITIONING FACILITY

DESIGN BY:
PRO INDUSTRIES

1-800-875-5448

FRANKLIN, IN

SCALE:
1" = 12'

DATE:
05-03

3 LANE TRACK

ROOM SIZE 110' X 105'

PLYOMETRIC AREA

AREA LEFT OPEN FOR BLEACHERS 12' X 85'

VKR/DIP (3)

LAT PULLDOWN (6)

ADJ CABLE SYSTEM

LEG EXTENSION (6)

STANDING CALF RAISE (3)

ANGLED LEG PRESS (6)

TEACHER AREA
8'X8'

SELF CONTAINED POWER STATION (18)

LEG CURL (6)

AUSTIN LEG DRIVE (2)

ABDOMINAL CRUNCH BENCH (6)

COMBO GLUTE HAM / REVERSE HYPER (6)

POWER PRESS (2)

PREACHER CURL BENCHES (6)

DUMBBELL AREA (2 SETS 5-50, 1 SET 55-100)

North Central High School

STRENGTH AND CONDITIONING FACILITY

DATE: 06-08

SCALE: 1" = 10' FRANKLIN, IN

1-800-875-5448

DESIGN BY: PRO INDUSTRIES